



Rutland Road
, Southall UB1 2XS

- Two bedroom house
 - Conservatory
- Modern bathroom
 - Private garden
 - Sole Agent
- Spacious lounge
- Separate kitchen
 - Freshly decorated
 - Ready now
 - Family house

£1,995 Per Month





Location





Local Authority **Ealing**
Council Tax Band **C**
EPC Rating **C**

111 Rutland Road Plan

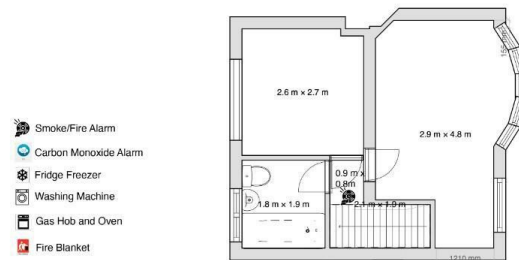
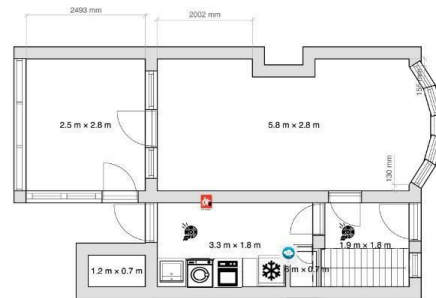

Mill Hill Office

Concorde House Grenville Place, Mill Hill,
London, NW7 5SA

Contact

02035441561
raphael@housemanhomes.co.uk
www.houseman-properties.com

Agents Note: Whilst every care has been taken to prepare these particulars, they are for guidance purposes only. All measurements are approximate and for general guidance purposes only and whilst every care has been taken to ensure accuracy, they should not be relied upon and potential buyers/tenants are advised to recheck the measurements.